

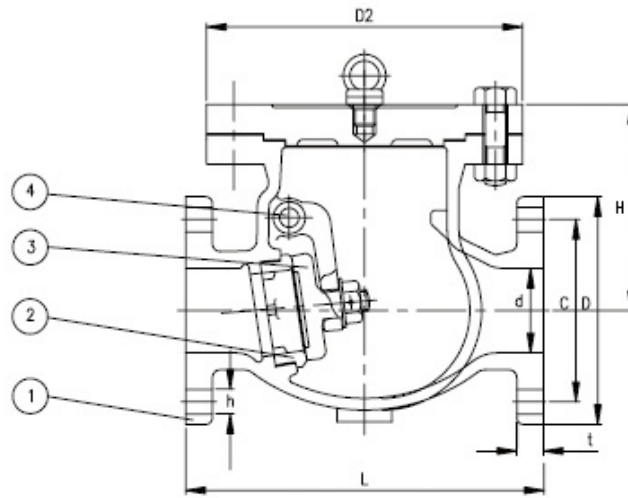

**ARINE CAST IRON 5K SWING CHECK VALVE - JIS F7372**  
**MARINE CAST IRON 10K SWING CHECK VALVE - JIS F7373**

Manufactured in accordance to JIS F7400  
 Flanges as per JIS B2220 - 5K & 10K



No.	Component	Material
1	Body	Cast Iron
2	Hinge	Brass
3	Disc	Bronze
4	Seat	Bronze

Nominal Pressure		5K	10K
Hydraulic Inspection	Body	1.03[10.5]	2.06[21.0]
	Seat	0.39[4] ~ 0.76[7.7]	0.39[4] ~ 1.51[15.4]

Size	F7372									F7373								
	L	D	C	No.	h	t	H	D2	Kg	L	D	C	No.	h	t	H	D2	Kg
50A	190	130	105	4	15	16	97	135	9.06	210	155	120	4	19	20	109	150	13.6
65A	220	155	130	4	15	18	119	155	13.9	240	175	140	4	19	22	126	170	19.6
80A	250	180	145	4	19	18	129	185	19.1	270	185	150	8	19	22	136	185	22.6
100A	280	200	165	8	19	20	146	205	27.1	300	210	175	8	19	24	153	205	30.9
125A	330	235	200	8	19	20	171	235	39	350	250	210	8	23	24	180	250	49.2
150A	380	265	230	8	19	22	198	265	53.7	400	280	240	8	23	26	205	275	64.9
200A	460	320	280	8	23	24	235	300	94.4	480	330	290	12	23	26	242	330	103
250A	550	385	345	12	23	26	290	390	150	-	-	-	-	-	-	-	-	-